



SWIMMING POOLS

Whether you plan on installing an above ground pool, an inflatable pool or an inground pool, there are certain Town By-laws that must be followed.

ZONING BY-LAW & POOL ENCLOSURE BY-LAW

All pools and accessory buildings, regardless of size, must comply with the provisions of the Town of Tillsonburg zoning by-law and Pool Enclosure by-law.

These requirements include:

- The location of the pool is required to be located in the side, or rear yard. Pools are not permitted to be located in the required front yard
- Swimming pool setback from property lines (generally a minimum of 4 ft (1.2 m))
- Minimum height for pool enclosures is 5 feet (1.52 m)
- Also take drainage issues into consideration when locating your pool
- All swimming pools must be enclosed by fencing complying with the Town of Tillsonburg fence by-law 4008. (See attached for excerpts)

BUILDING PERMITS

A complete Building Permit Application requires the following:

- A completed CloudPermit application (<https://ca.cloudpermit.com/login-form>)
- A site plan/survey showing your proposed swimming pool, existing and or proposed fencing, pool equipment (pump, heater, etc.), and any other proposed structures accessory to the pool indicating their location and setbacks to property lines (see attached example of a typical site plan required for your permit application).
- A lot grading plan designed by a Registered Professional Engineer or Ontario Land Surveyor if a semi-inground or inground pool is proposed.

If your proposal includes the construction of a deck, shed etc.; a copy of your building plans drawn to scale. The drawings must have sufficient detail so that someone, following the drawings, could build the structure (see information sheet on decks/sheds).

SITE PLAN

NOTE: Provide the length of all the property lines and dimensions to all of the buildings on the property. The site plan provided for review, must reference a survey of the property and a copy of the survey used is to be submitted with the application form. An existing survey may be photocopied to show the location of the proposed building.

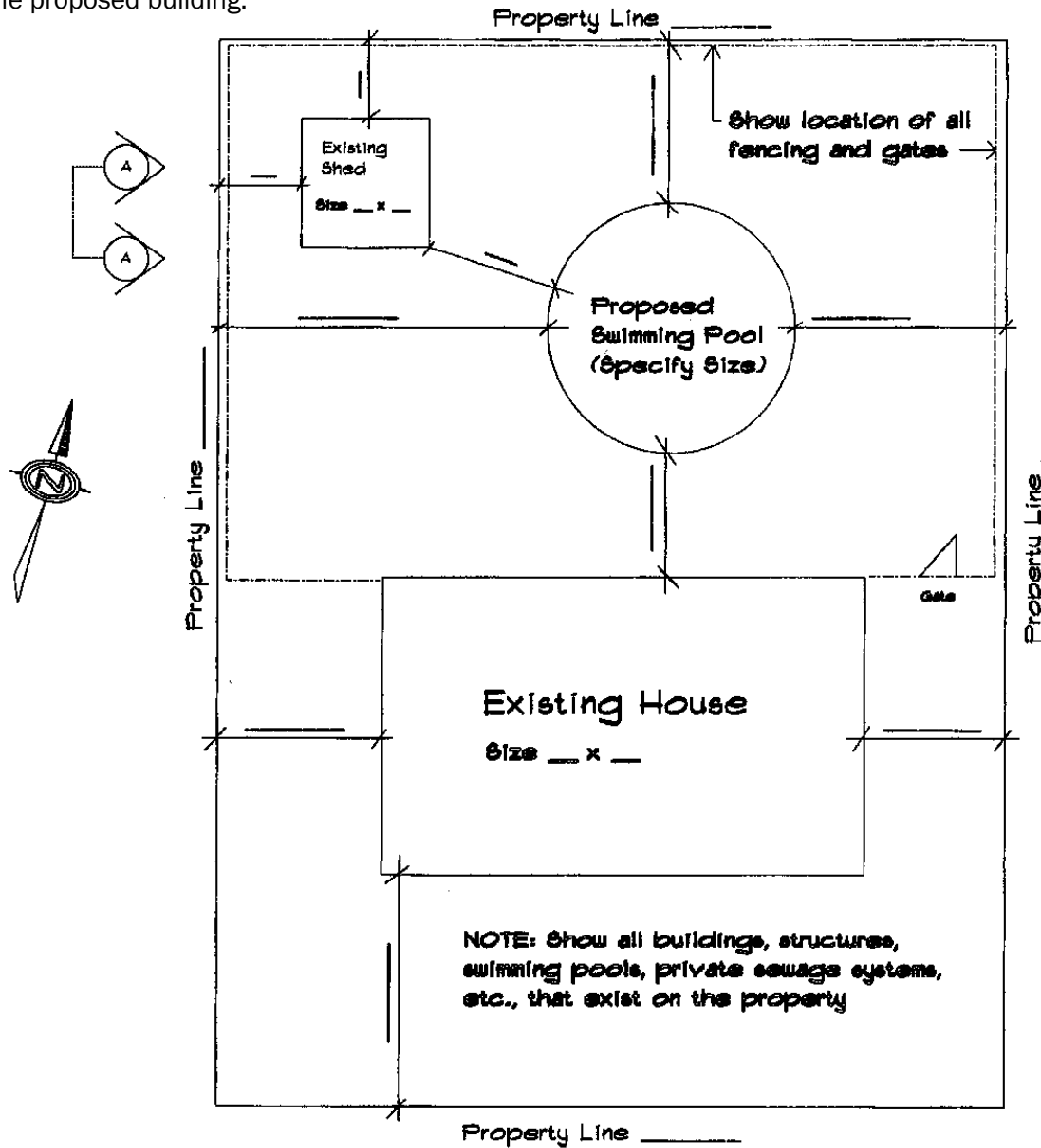

Street Name

Show all streets, laneways, etc. abutting the property, any easements pertaining to the property and any power lines above or adjacent the proposed building.